

Air Filter 100 CFM Retrofit Kit Installation



WARNING: Allow only qualified personnel to perform the following tasks. Follow the safety instructions in this document and all other related documentation.

Description

Use this instruction sheet to replace discontinued filter assemblies with the new air filter 100 CFM. See Figure 1 for a list of the systems and filters affected.

iControl® 2 System
Filter Assembly: 1602855

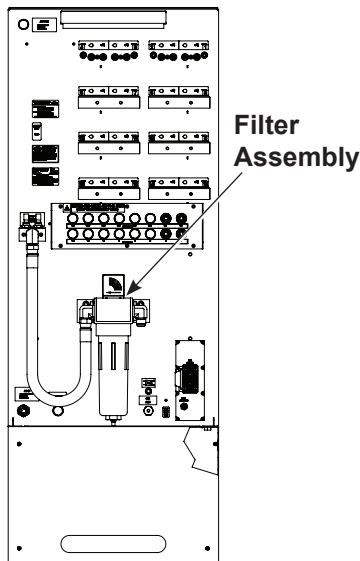

HDLV® Spray Gun Pump Stand
Filter Assembly: 1047526

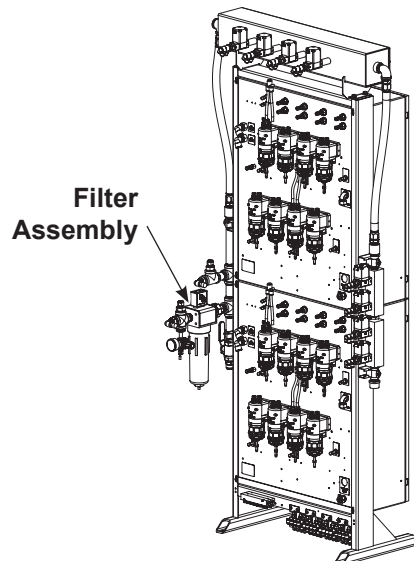

iControl Automatic Spray Gun Console
Filter Assembly: 1047526

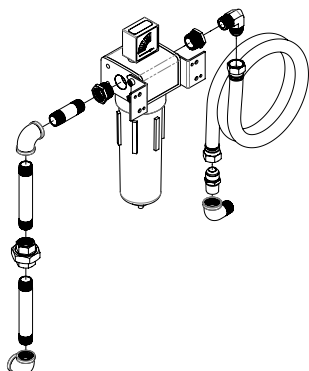

Automatic Gun Console
Filter Assembly: 1047526

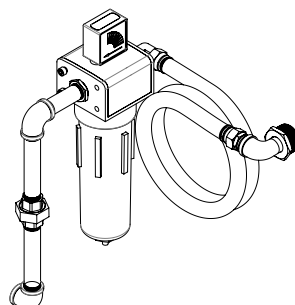

Spectrum® HD Feed Center
Filter Assembly: 1047526

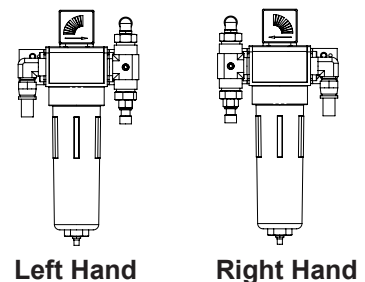

Figure 1 Systems and Filters Affected

Filter Replacement

The hardware and connections used with existing filters are application specific. The retrofit kit is designed to work with all system configurations listed in Figure 1 and is compatible with these systems' existing hardware and connections.



WARNING: Shut off and relieve system air pressure before performing the following tasks. Failure to relieve air pressure may result in personal injury.

1. Power OFF the electrical to the system and turn off the air to the filter assembly. Depressurize/bleed off air from the air supply line connected to the existing air filter.
2. Assess the installation of the existing filter for proper integration of the new filter. Take note of the following:
 - Directional arrow on filter to determine flow of air in and out of the filter
 - Mounting requirements such as bracket, position on cabinet, or part of air header manifold
 - Existing hardware, fittings, and connectors
3. Refer to Table 1 and the *Parts* section to further determine what parts from the retrofit kit are needed for the specific system configuration.

NOTE: Table 1 shows the most common items needed from the retrofit kit for each system. Use this table in conjunction with the assessment done in step 2 to determine how to replace the filter in the next steps.

Table 1 Retrofit Kit Parts for System Configurations

Item	Short Description	iControl 2 System	HDLV Spray Gun Pump Stand	iControl Automatic Spray Gun Console	Automatic Gun Console	Spectrum HD Feed Center	Note
1	Mount plate	X				X	
2	Air filter	X	X	X	X	X	
2a	Bracket	X				X	
2b	Socket screws	X				X	
NS	Filter element	X	X	X	X	X	A
3	Spacial nuts	X				X	
NS	Flat washers					X	

NOTE: A. Pre-installed in air filter.

NS: Not Shown

4. Remove the existing filter along with any interconnecting fittings to be used on the new filter.



CAUTION: When wrapping fitting pipe threads make sure no PTFE tape over-hangs the fitting end being screwed into the filter body. This ensures that no loose pieces of tape or pipe thread sealant get into internal air passages of air filter. Any loose materials may result in damage to controls.

5. Using PTFE pipe thread tape, wrap the threads of fittings that are to be installed into new filter assembly.

6. Assemble any needed existing interconnecting fittings onto the new filter. Make sure the inlet and outlet ports are installed correctly so that the air flows in the same direction as the old filter. Use the directional arrow on the filter as a guide for how air should flow through the filter. The arrow should match the orientation of the old filter as noted in step 2.
7. Install the new filter assembly onto the system with the appropriate mounting hardware.

NOTE: For systems using a bracket, the bracket can be installed on either side of the filter to accommodate the correct direction of air flow. Figure 2 shows the bracket (2a) installed for right-to-left air flow direction. If left-to-right air flow is required, install the bracket on the opposite side of the filter.

Parts

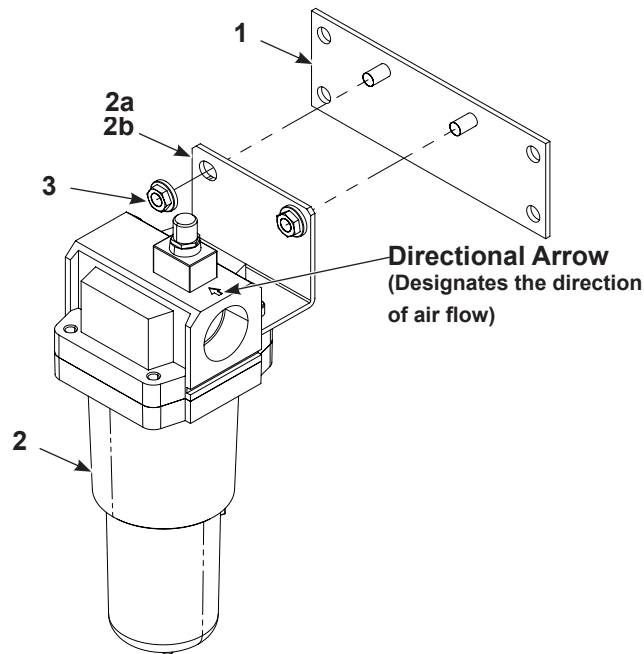

Figure 2 Retrofit Kit Parts

Item	Part	Description	Quantity	Note
—	1621215	KIT, RETROFIT, 100 CFM AIR FILTER	1	
1	1620009	PLATE, MOUNT, AIR PREP, ICONTROL	1	
2	1620010	FILTER, AIR, AF60, 5 MICRON, 1 IN. NPT , WITH BRACKET AND INDICATOR	1	
2a	-----	• BRACKET, AIR FILTER	1	
2b	-----	• SCREW, SOCKET, M6 x 10, ZINC	2	
NS	1614705	• ELEMENT, FILTER, AIR, 5 MICRON	1	A, B
3	1028341	SPACIAL NUT, FLANGE, 3/8-16, STEEL, ZINC, SERRATED	2	
NS	983034	WASHER, FLAT, M, OVERSIZED, 6, STEEL, ZINC	4	

NOTE: A. Pre-installed in air filter.

B. Filter element 1614705 is only compatible with 1620010 filter assembly. 1614705 is not interchangeable with old 1047524 filter element from previous filters.

NS: Not Shown

Issued 07/21

Original copyright date 2021. HDLV, iControl, Spectrum, Nordson, and the Nordson logo are registered trademarks of Nordson Corporation.

All other trademarks are the property of their respective owners.