

Measures: millimeter [inch]

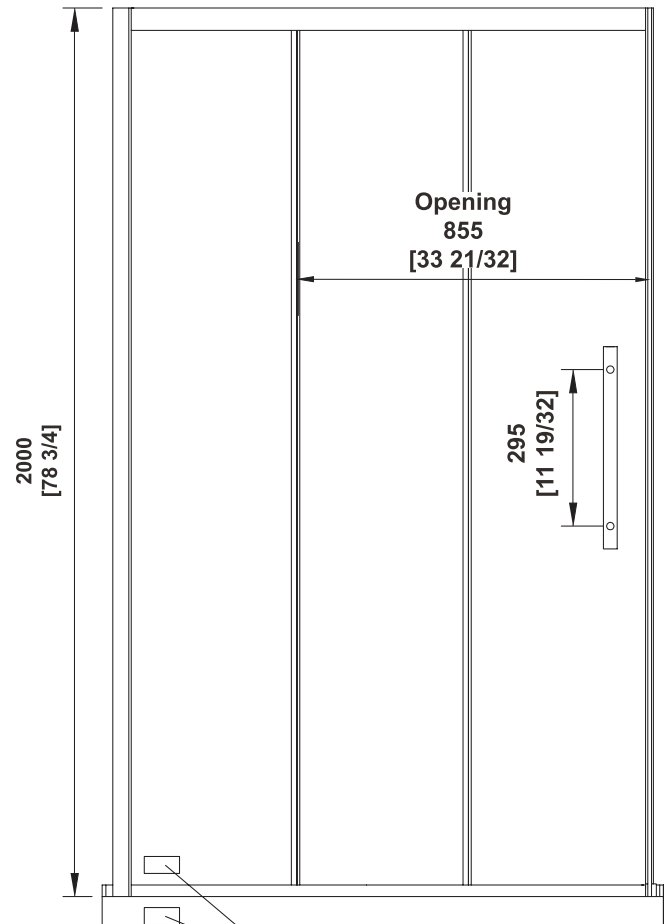
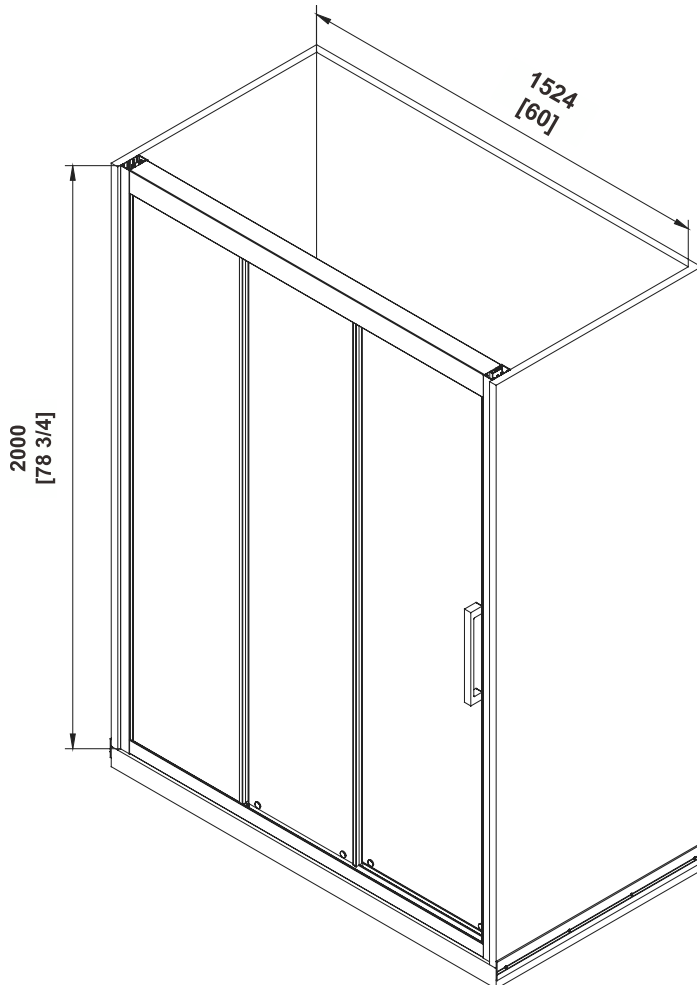

CSA Markings

An installation video guide can be found on our Youtube channel (Search for **Granada**).

www.youtube.com/user/ovedecors1

Purchase date: _____

Product Tracking Reference: _____



Questions, problems, missing parts?

Before returning to your retailer, call our customer service department at
1-866-839-2888, 9 a.m. - 5 p.m., EST, Monday - Friday

TABLE OF CONTENT

PACKAGE CONTENT.....	4
HARDWARE CONTENT.....	5
TOOLS REQUIRED.....	5
SAFETY INFORMATION.....	6
PREPARATION.....	6
SHOWER REVERSIBILITY.....	7
WALL TO WALL MEASURES.....	7
BASE INSTALLATION GUIDELINES (OPTIONAL).....	8
FIXED PANEL INSTALLATION.....	9
TOP TRACK INSTALLATION.....	11
ROLLING TRACKS INSTALLATION.....	12
WALL TRACKS INSTALLATION.....	14
WALL JAMBS INSTALLATION.....	15
SHOWER ENCLOSURE INSTALLATION.....	16
DOOR INSTALLATION.....	17
STOPPER AND STRIPS INSTALLATION.....	19
RUBBER STRIPS INSTALLATION.....	20
HANDLE INSTALLATION & SEALING.....	21
CARE AND MAINTENANCE.....	22
LIMITED 5 YEARS WARRANTY.....	22

PACKAGE CONTENT

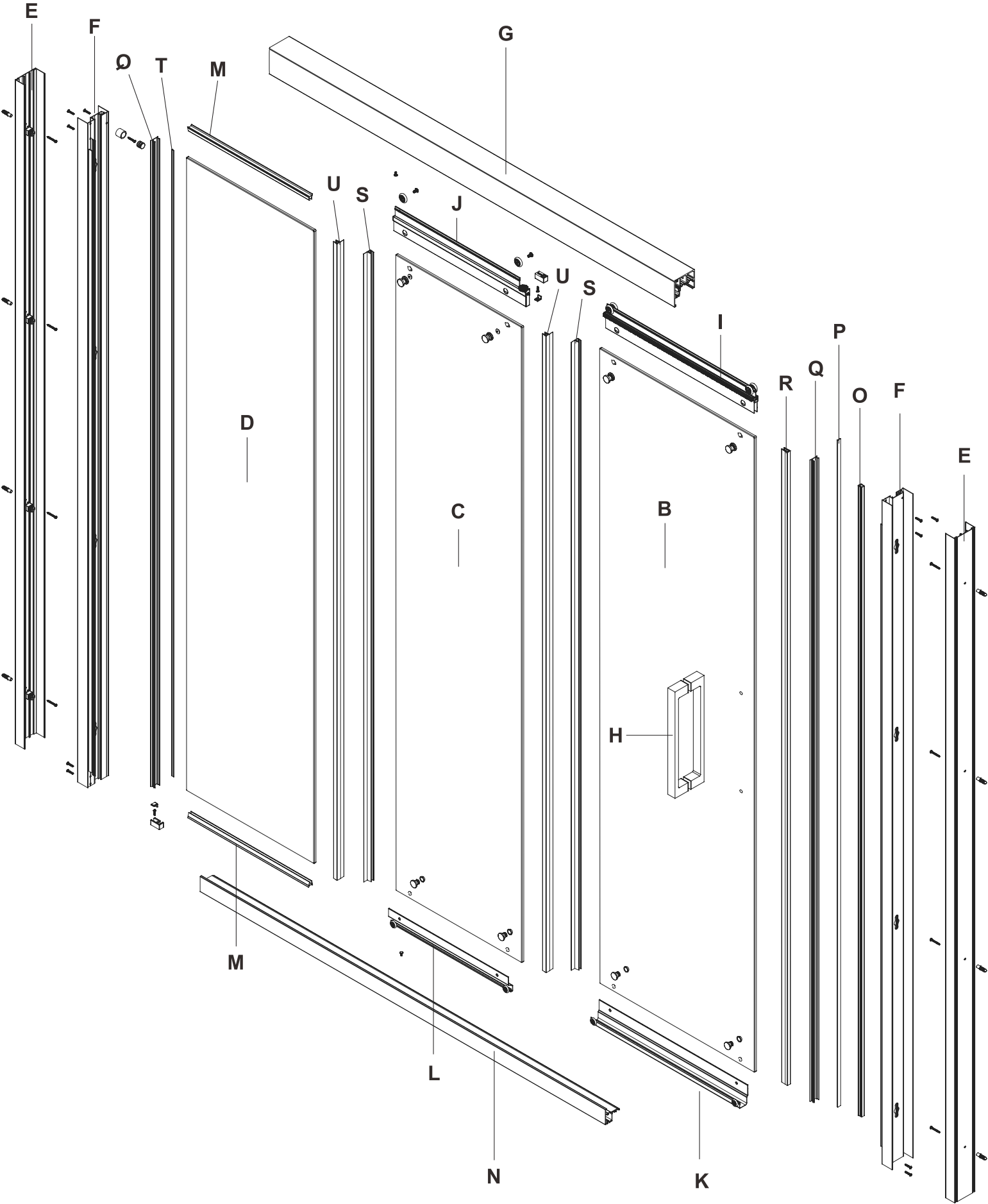

PACKAGE CONTENT

PART#	DESCRIPTION	QTY	CODE
B	Shower door	1	99SGD3107-WM
C	Center panel	1	99SG31008-WM
D	Fixed panel	1	99SG31009-WM
E	Aluminum wall tracks	2	99STR3114-WM
F	Aluminum wall jamb	2	99STR3115-WM
G	Top metal track	1	99SGS3110-WM
H	Door handle	1	99SHA3108-WM
I	Door rolling track	1	99SWE3110-WM
J	Cener panel rolling track	1	99SWE3111-WM
K	Door bottom rolling track	1	99SWE3112-WM
L	Center panel bottom rolling track	1	99SWE3113-WM
M	Horizontal rubber strips	2	99SRU0076
N	Bottom metal track	1	99STR3116-WM
O	Vertical rubber strip	1	99SRU0075
P	Magnetic strip	1	99SRU0070
Q	Aluminum covers	2	99STR3117-WM
R	Door magnetic track	1	99SRU0071
S	Vertical rubber strips (Long)	2	99SRU0072
T	Gasket	1	99SRU0073
U	Vertical rubber strips (Short)	2	99SRU0074

HARDWARE CONTENT

AA

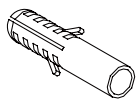

Wall Anchor
ø6x30mm
8+2

BB

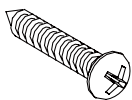

Screw
ST4x35mm
8+2

CC

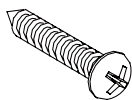

Screw
ST4x20mm
10+2

DD

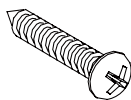

Screw
ST4x12mm
3+1

EE

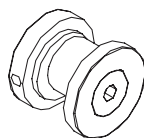

Top glass bracket
4x

FF

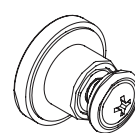

Bottom glass bracket
4x

GG



Bottom bracket cap
4x

HH

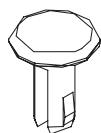

Cap
2x

II

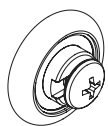

Wheels with thread
2 extra

KK



Plug
1x

LL



Stopper
1x

MM

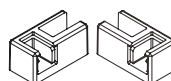

Fixed Panel support
1+1

NN



Support cap
2x

OO



Top bracket cap
4x

TOOLS REQUIRED



Pencil



Screwdriver



Drill with ceramic tile bit
ø3mm (1/8 in) & ø6mm (1/4 in)

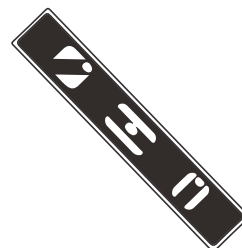

Level



Measuring Tape

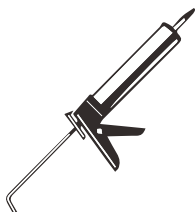

Silicone



Rubber mallet



Cutter



Safety glasses

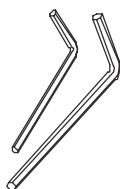

Allen key
2mm & 2.5mm & 3mm

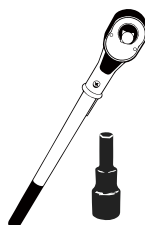

Ratchet
5mm Bit socket

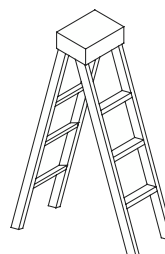

Ladder

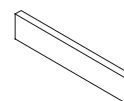

Wood stick



SAFETY INFORMATION

Please read and understand this entire manual before attempting to assemble, operate or install the product.



Handle the tempered glass with caution! Improperly handling the glass can cause it to break suddenly in small pieces (never in pointed fragments).

Do NOT put glass panels on hard surfaces, always work on clean and soft surface (e.g. towel). Shattering may occur otherwise!

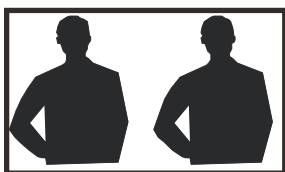

HEAVY PRODUCT! You will need at least two people to install this unit properly.

WARNING

- Distributor is not responsible for any damage to the unit or personal property caused by improper installation. If you disregard instructional warnings, you will void your warranty and possibly deal with water damage.

CAUTION

- Carefully remove product from packaging and keep packaging until installation is complete.
- Inspect all parts for damage; if there is damage to the unit prior to installation, please contact customer service at the number provided in this guide.
- Install the shower on a floor that is level and able to accommodate the weight of the unit and an occupant.
- Please, consult local building codes and compliance standards prior to installation and ensure conformity.

PREPARATION

Before beginning assembly of product, make sure all parts are present. Compare parts with package contents list and hardware contents list. If any part is missing or damaged, do not attempt to assemble the product.

Estimated Assembly Time 120min.

SHOWER REVERSIBILITY

- This instruction is drawn up for an opening from right to left (see illustration B).
- For an installation from left to right (see illustration A), use the same instructions, but switch around the panels: mirror effect.

! Install the shower head on the door's side! This will reduce the risk of leaking.

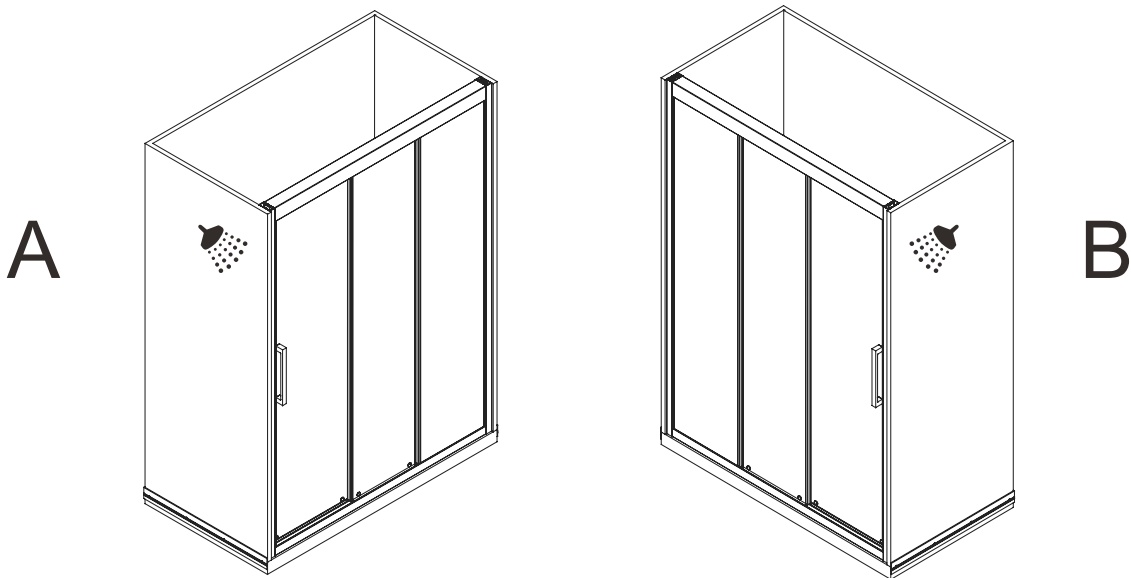

WALL TO WALL MEASURES

- Measure the thickness of your tiles on either side before installing the metal tracks. A thicker tile will limit your space to install the shower panels.
- Make sure to have a tile to tile distance (D) between 1480mm (58 1/4 in) min. and 1500mm (59 1/16 in) max. (see image).

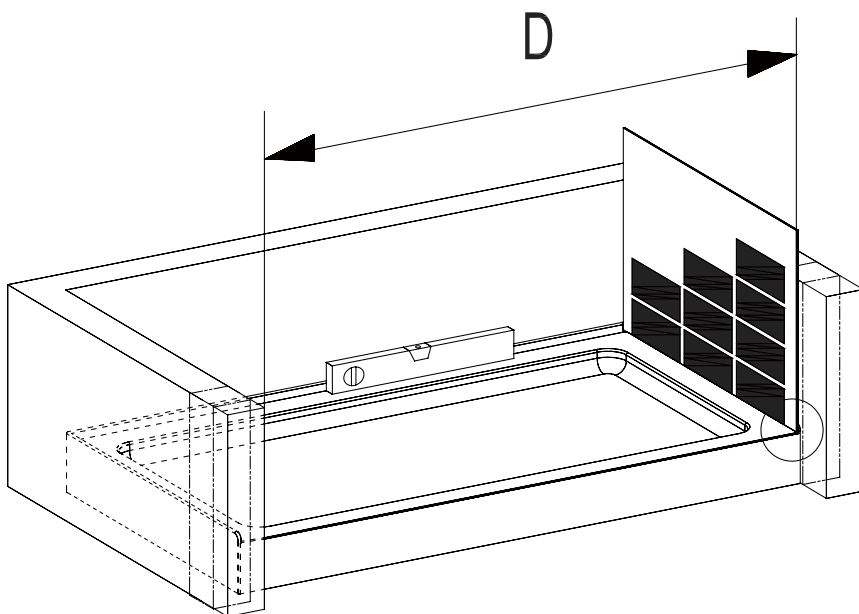

Make sure to have a distance (D) from the left side tile to the right side tile:

D Min: 1480mm (58 1/4 in)
D Max: 1500mm (59 1/16 in)

BASE INSTALLATION GUIDELINES (OPTIONAL)

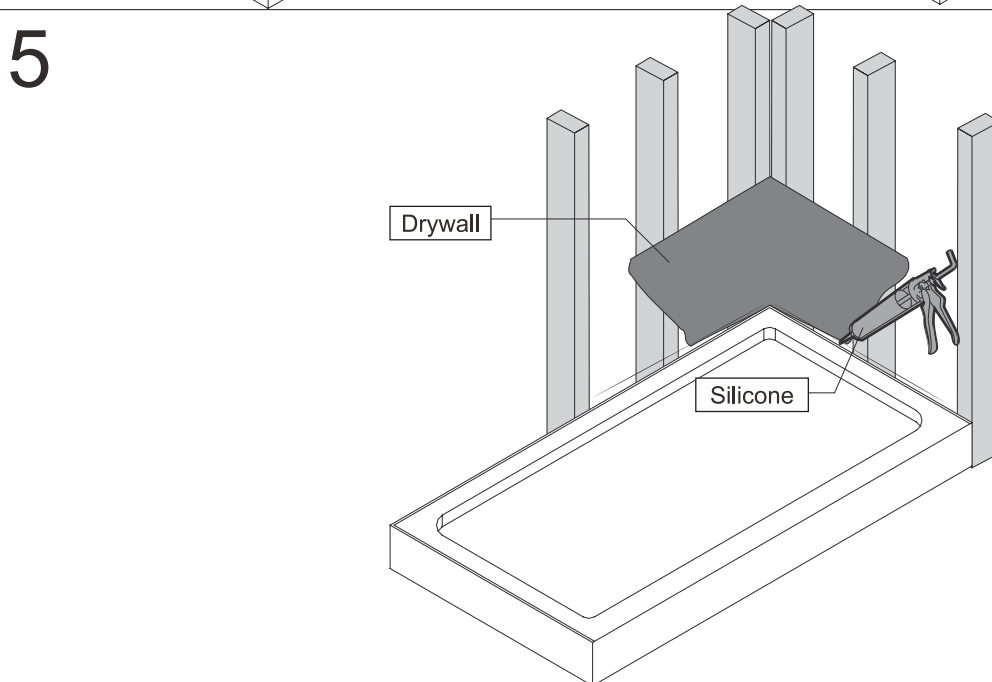
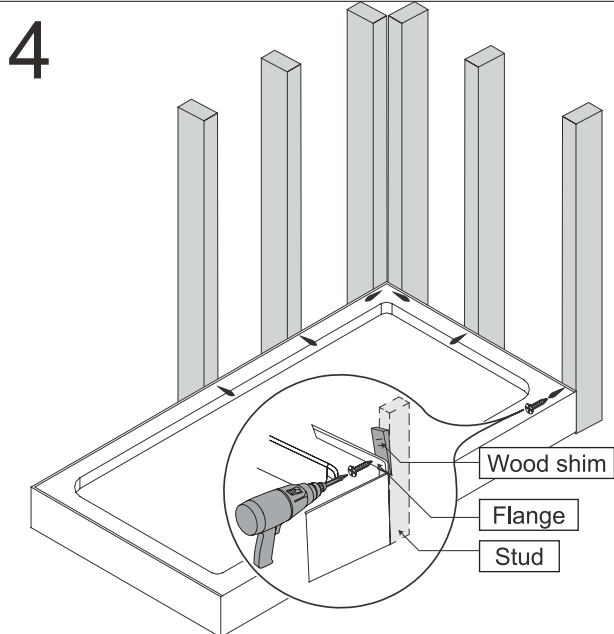
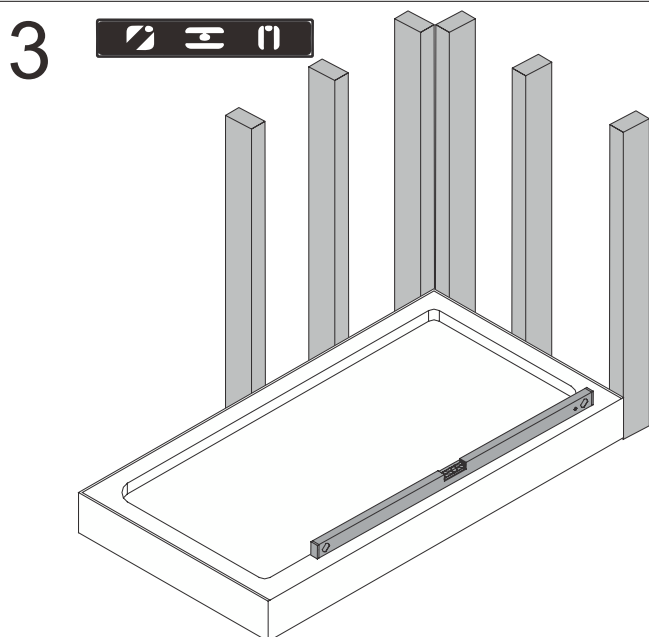
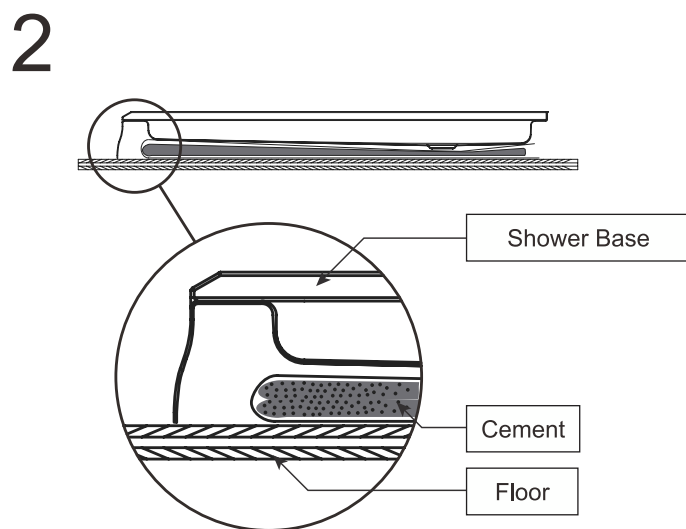
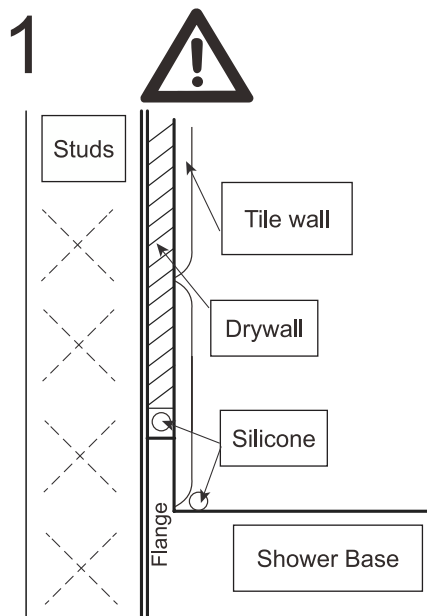

FIXED PANEL INSTALLATION

1. Install the clamp (MM) on the track (N) using screw (DD), and then insert the cap (NN).
- 2-3. Place the horizontal rubber strip (M) on the top of the fixed panel (D).
- 4-5. Place the horizontal rubber strip (M) on the bottom of the fixed panel (D).

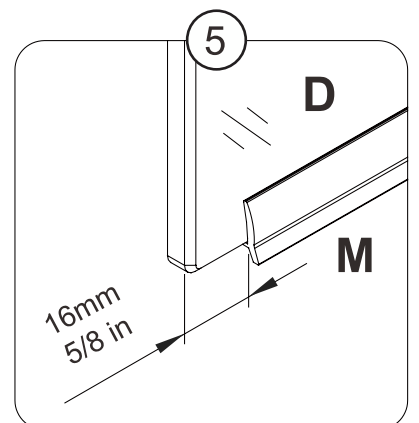
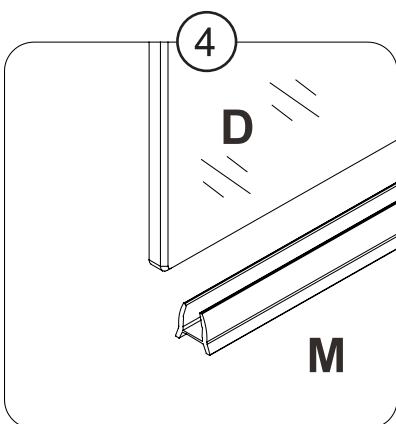
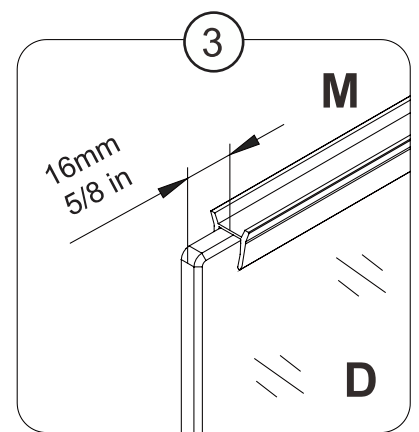
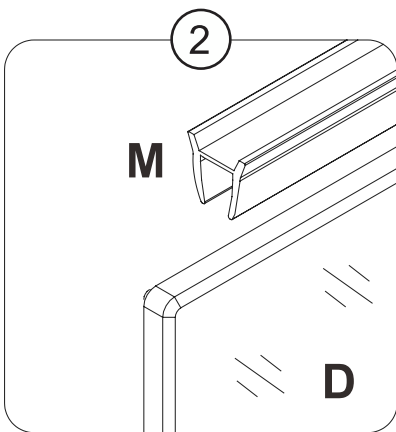
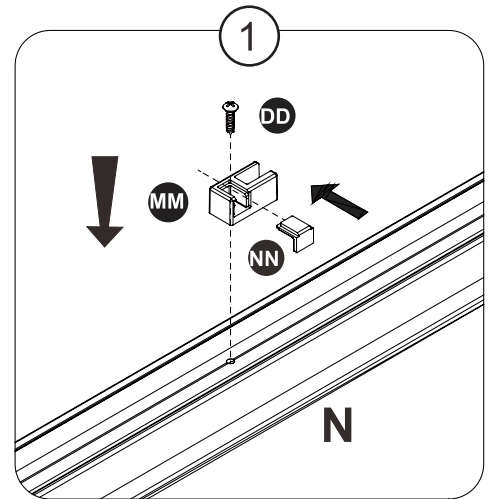
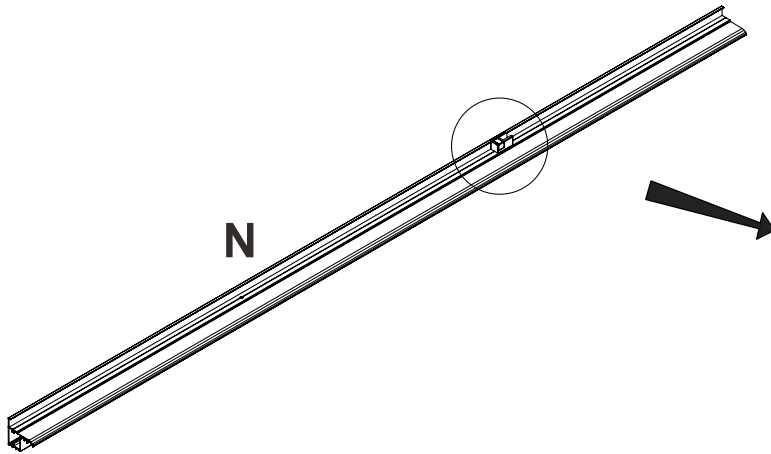

- 1-2. Place the fixed panel (D) on the bottom metal track (N).
3. Place the track (F) on the fixed panel (D).
4. Secure the track (F) using screws (CC).



TOP TRACK INSTALLATION

1-2. Install the clamp (MM) on the top track (G) using screw (DD), and then insert the cap (NN).

3-5. Place the top track (G) on the fixed panel (D) and secure the track (F) using the screws (CC).

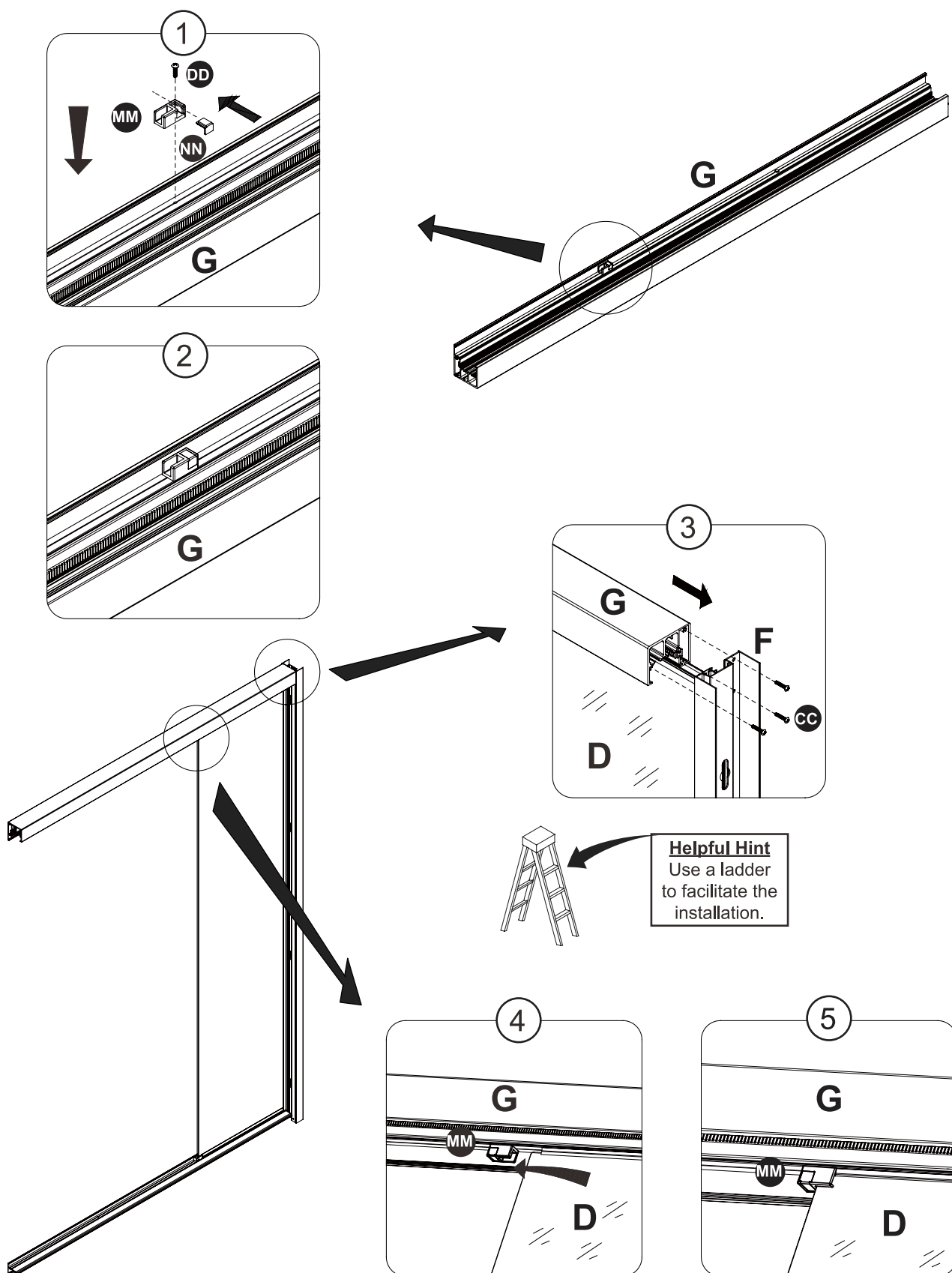

ROLLING TRACKS INSTALLATION

1-4. Wheels (II) have been pre-installed on the rolling track (J) for an installation from Right to Left, as shown in this manual. For an installation from Left to Right, switch the wheels on the opposite side.

 The wheels on the roller (J) are pre-assembled for a shower opening from **RIGHT to LEFT**. For a shower opening from **LEFT to RIGHT**, switch the side of the wheels as shown in steps 1 to 4.

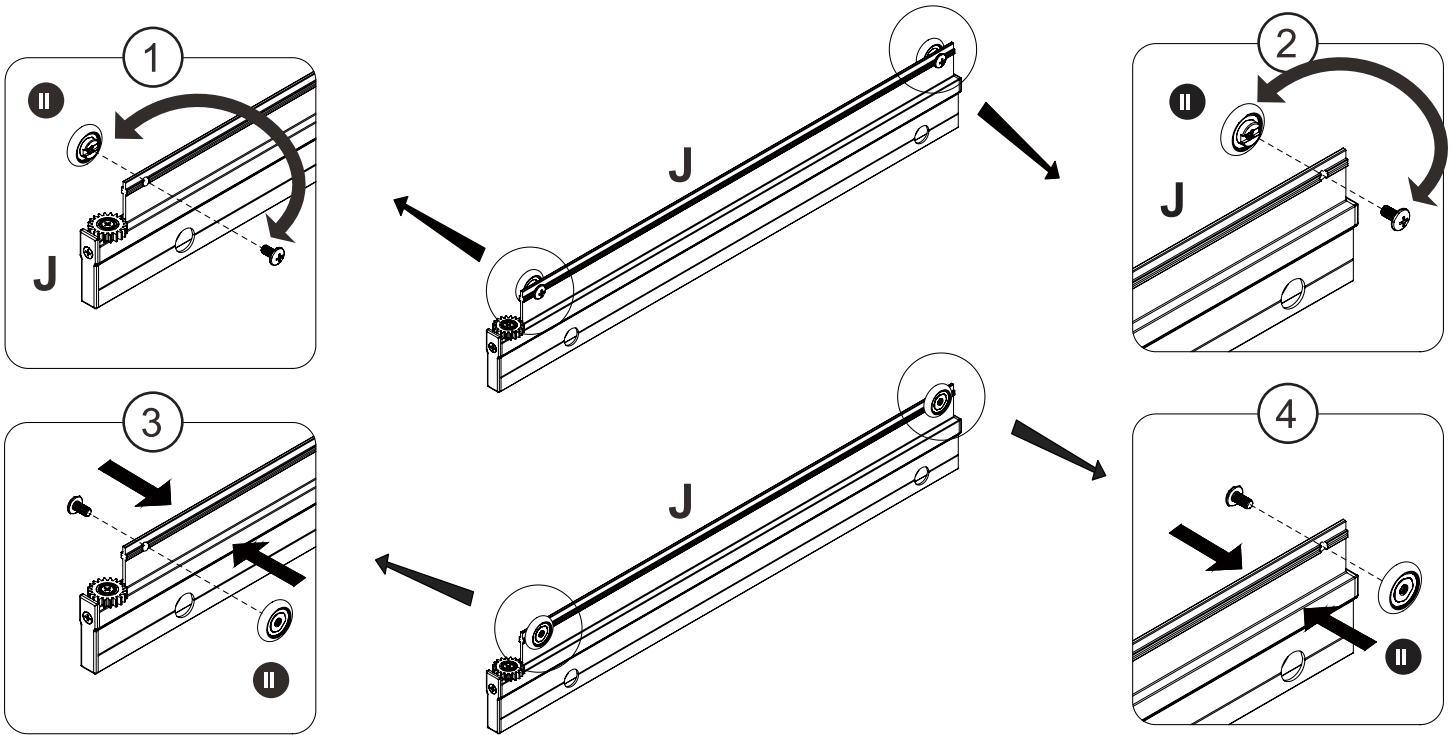

The image below is a guideline, jump to the next page for continued detailed instructions

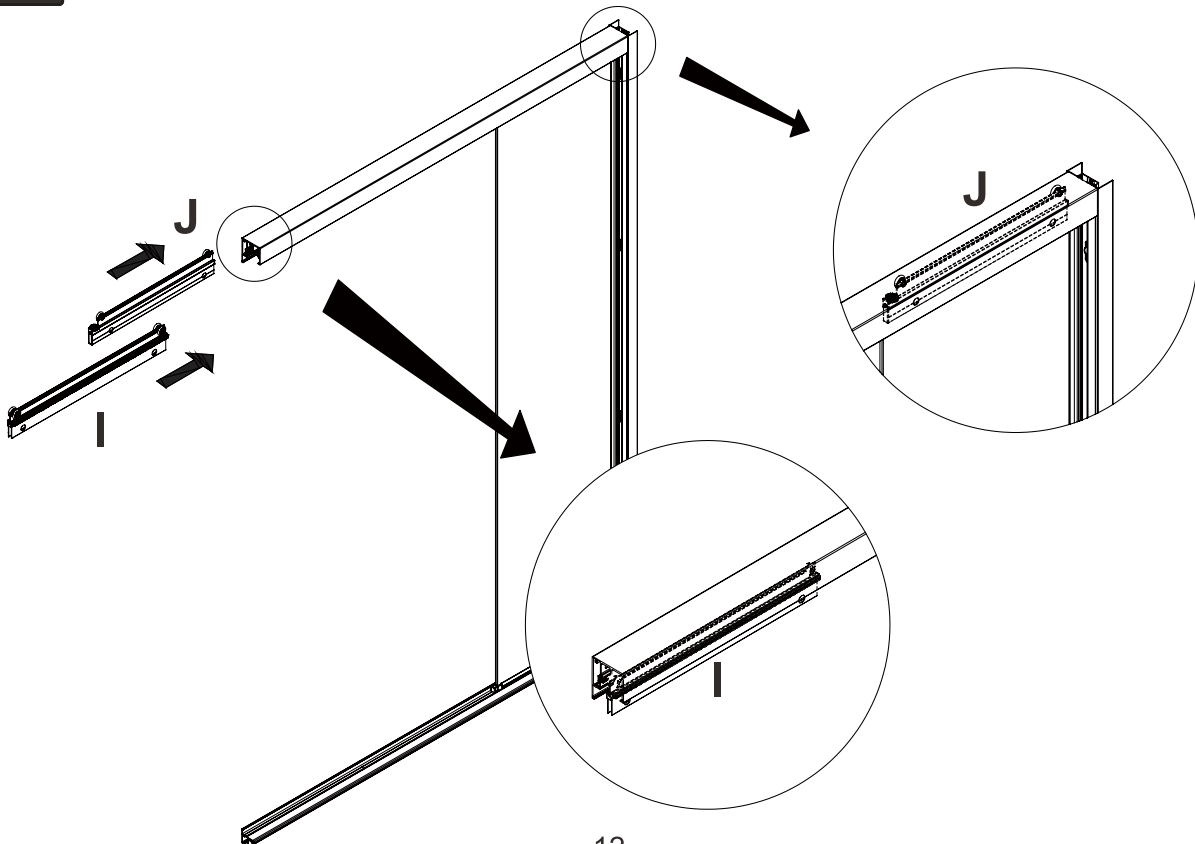

ROLLING TRACKS INSTALLATION

Note: These are important steps, carefully follow the instructions.

1. Slide the center panel rolling track (J) into the top track (G), and push it to the end of the rail.
2. Slide the door rolling track (I) into the top track (G).
- 3-4. Do not fully insert the track (I): Leave a 15mm (19/32in) gap between the entrance of the top track (G) and the end of the track (I).
5. Keep the door rolling track (I) steady. Gently push the center panel rolling track (J) back toward the track (I), until you feel both tracks' gears are slightly engaged.
6. Slide the door rolling track (I) and the center panel rolling track (J) together into the top track (G). They should now be paired.

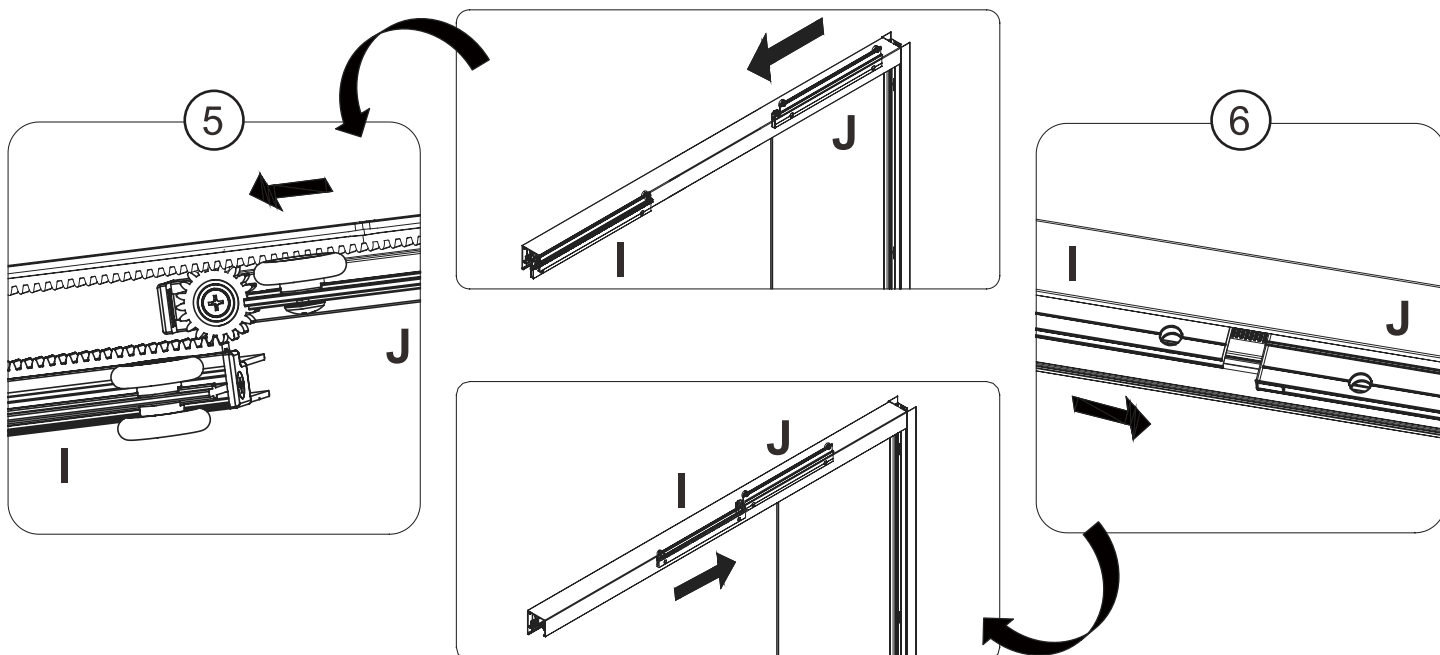
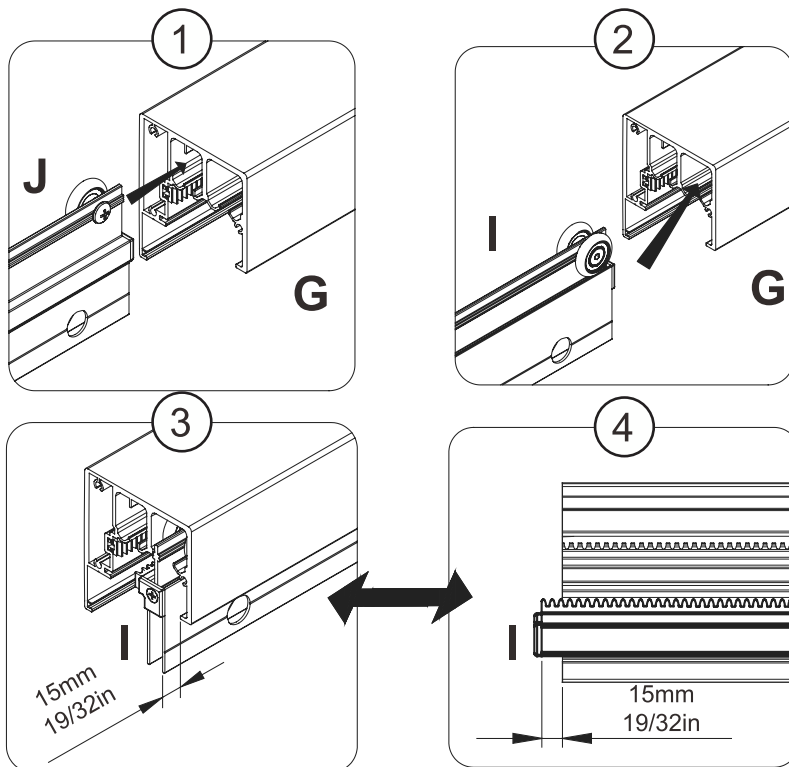

WALL TRACKS INSTALLATION

1-2. Install the track (F) on the top track (G) and the bottom metal track (N) using the screws (CC).

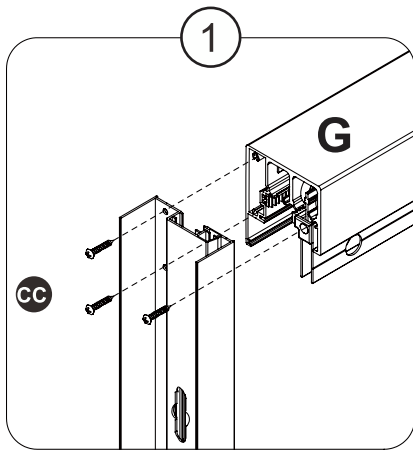

Helpful Hint
Use a ladder
to facilitate the
installation.

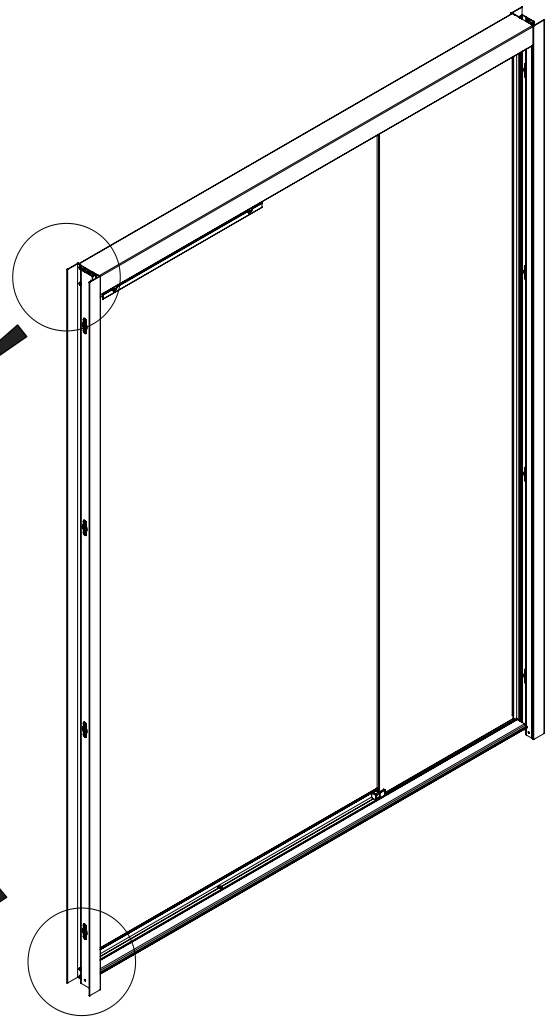
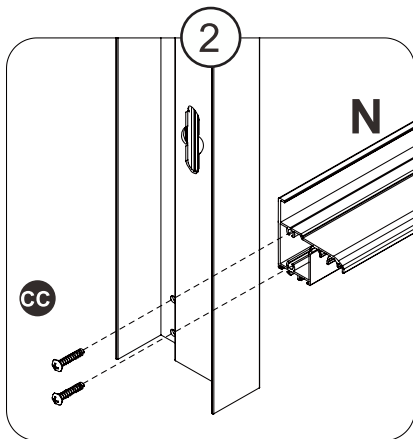
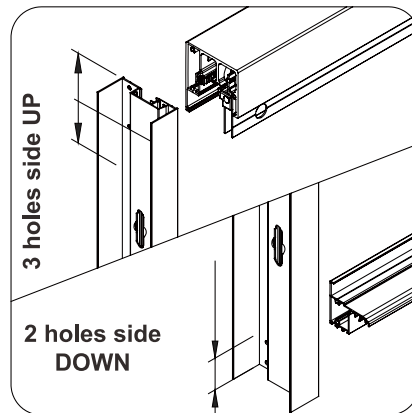

WALL JAMBS INSTALLATION

1. Remove the protective film from the wall jambs (E), loose the plastic screws and put them at the bottom of their slot.
- 2-3. Place the wall jambs (E) on the tracks (F) by adjusting the position of the plastic screws.
4. Lock both tracks together by pushing the plastic screw downwards in the slots of the track (F).
5. Place the whole shower frame onto the base.

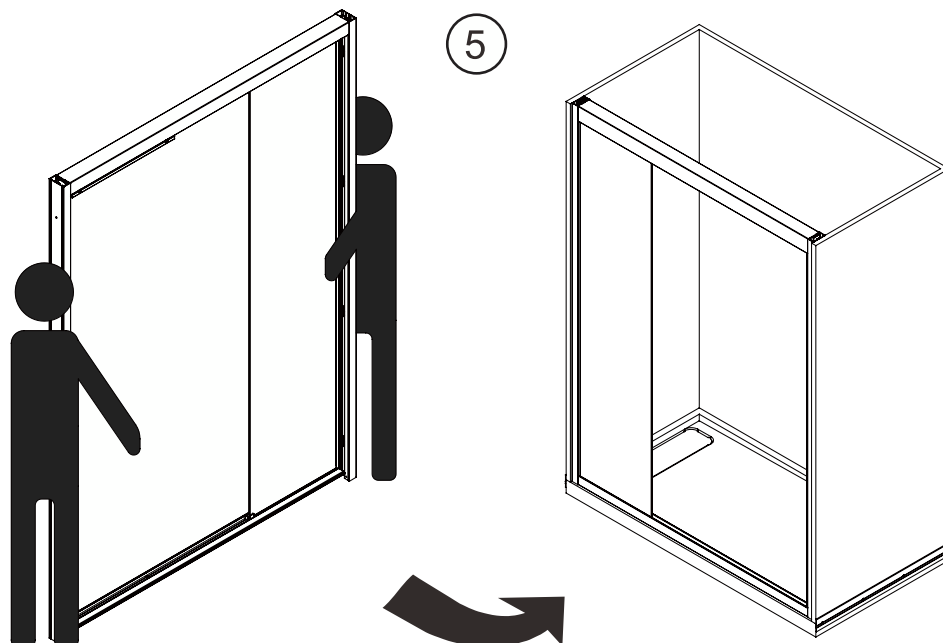
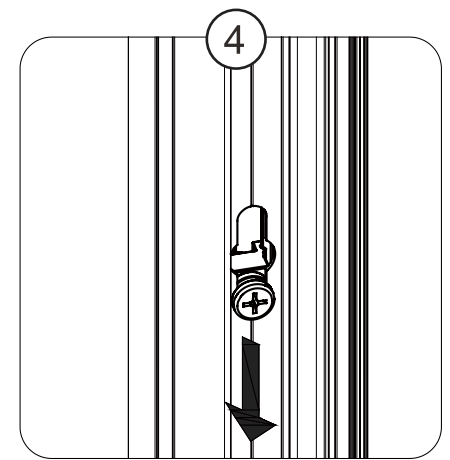
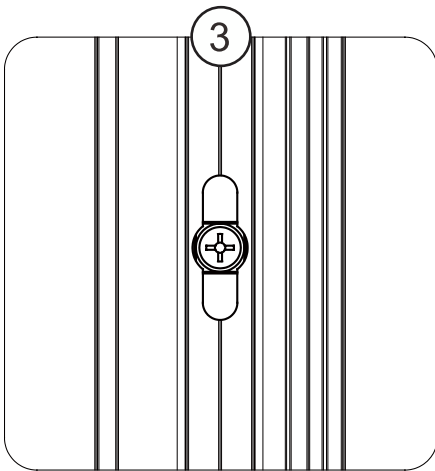
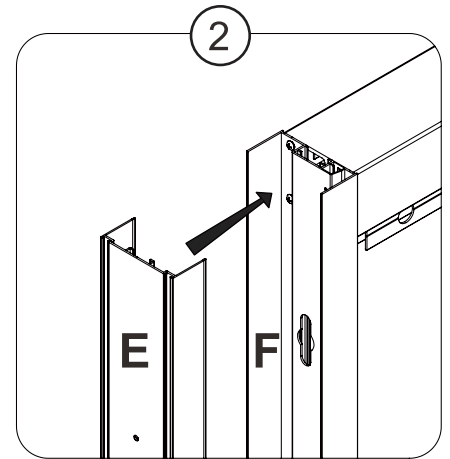
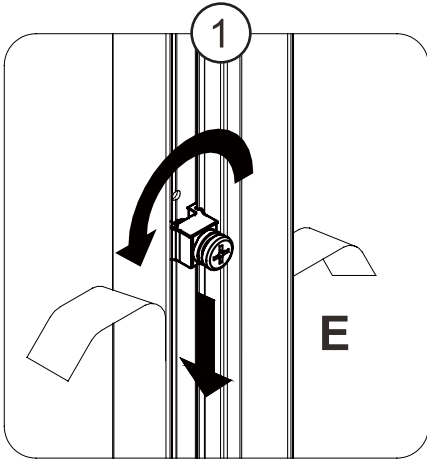

SHOWER ENCLOSURE INSTALLATION

1-2. Using the plastic screws on the wall jamb (E), adjust the level of the shower frame. Also, make sure it fits snugly between the 2 walls.

Note: A total of 8 plastic screws on the wall jamb (E) will help you adjust the level of the shower frame and make it snugly fit between the 2 walls.

3. Mark the position of the holes of the wall jambs (E) on the wall.

4-5. Remove the shower frame and drill guide holes with a $\varnothing 6\text{mm}$ (1/4in) drill bit.

6-7. Insert the wall anchors (AA) into the wall and put back the shower frame in place.

8. Replace the shower frame back on the base, and fix the shower frame onto the wall using screws (BB).

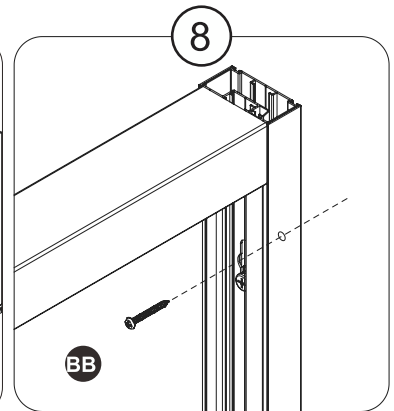
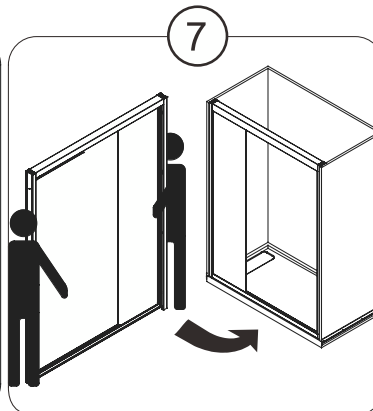
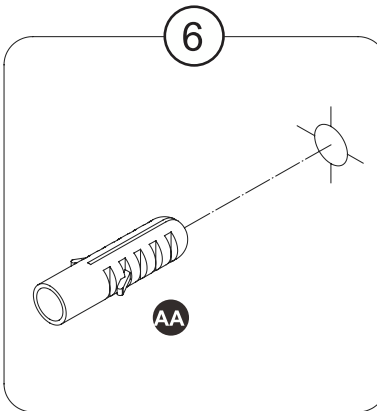
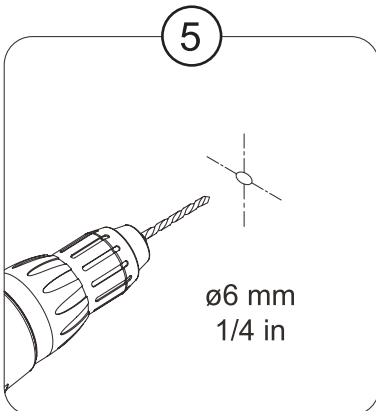
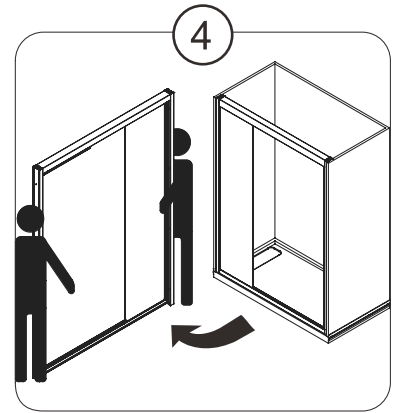
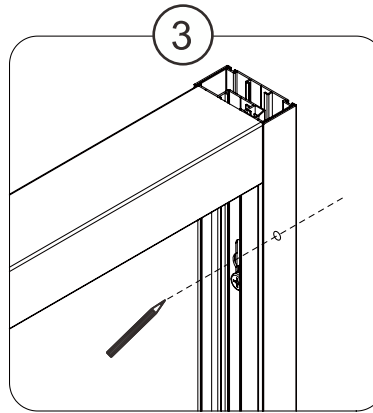
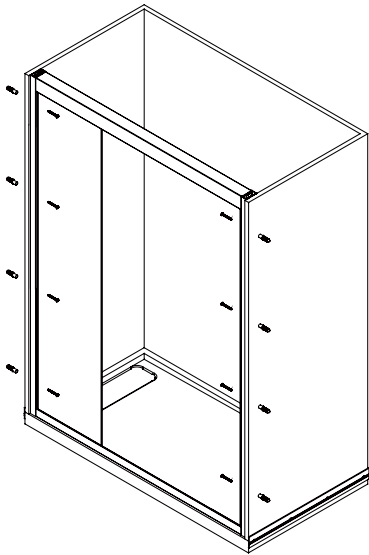
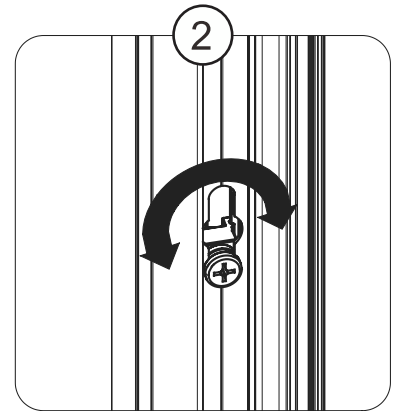
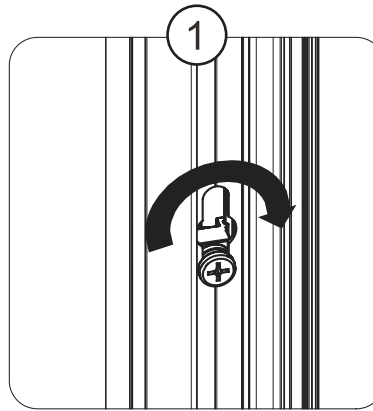
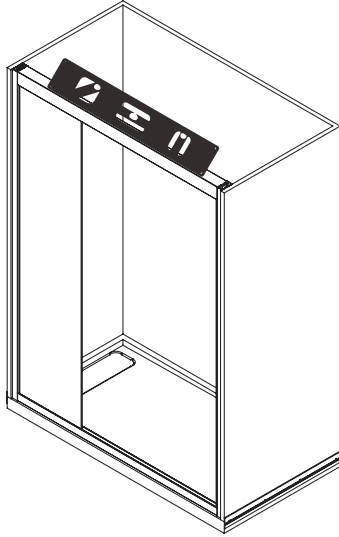

DOOR INSTALLATION

Note: 2 people are required for the following installation steps!

1-2. Install the center panel (C) on the rolling track (J) using glass brackets (EE) and caps (OO). Adjust the level of the glass panel using the eccentric mechanism of the brackets.

3-4. Install the bottom rolling track (L) on the bottom metal track (N) using bracket (FF) and cap (GG).

5. Insert the vertical rubber strip (O) to the track (F).

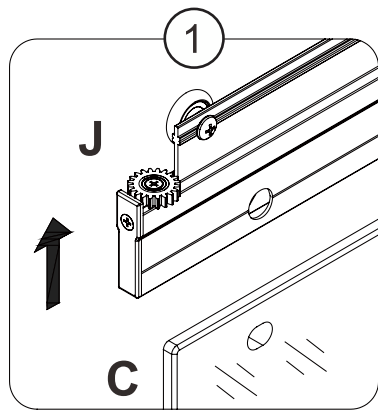

view from inside

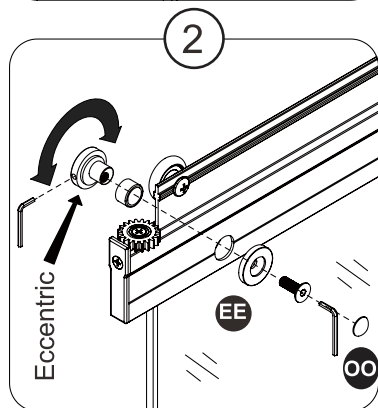

view from inside

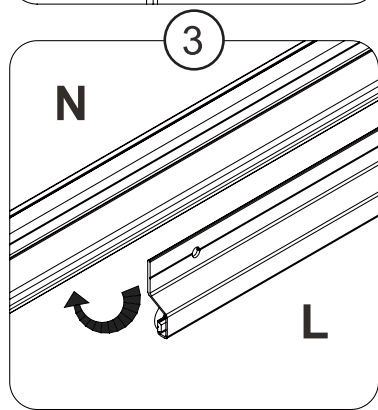

view from inside

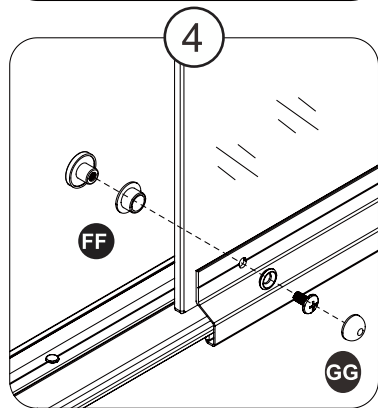

view from inside

Helpful Hint
The center panel has an up & down direction: make sure the side with OVAL holes is UP!

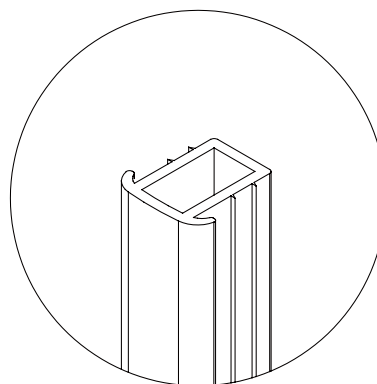
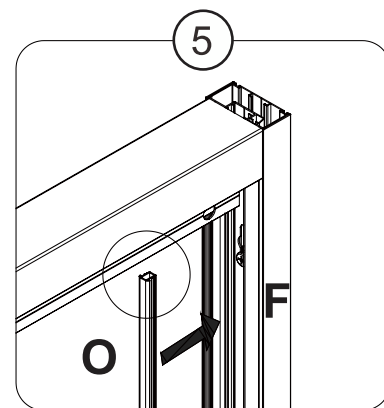
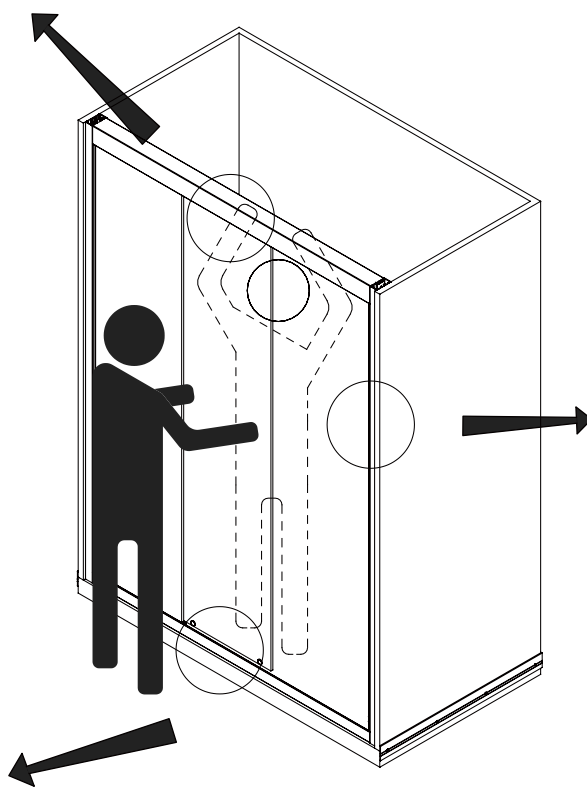

DOOR INSTALLATION

1-2. Install the shower door (B) on the door rolling track (I) using bracket (EE) and cap (OO). Adjust the level of the glass panel using the eccentric mechanism of the brackets.

3-4. Install the door bottom rolling track (K) on the bottom track (N) using bracket (FF) and cap (GG).

Helpful Hint

The door panel has an up & down direction: make sure the side with OVAL holes is UP!

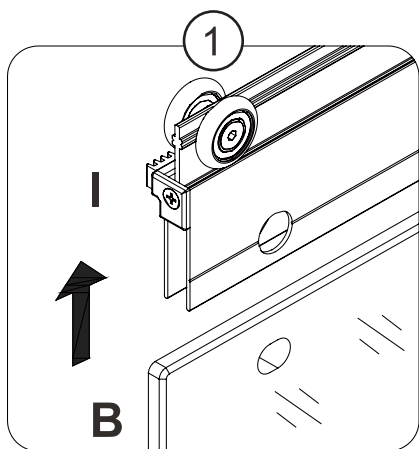

view from inside

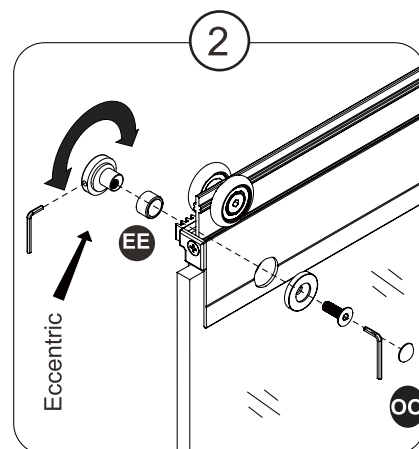

view from inside

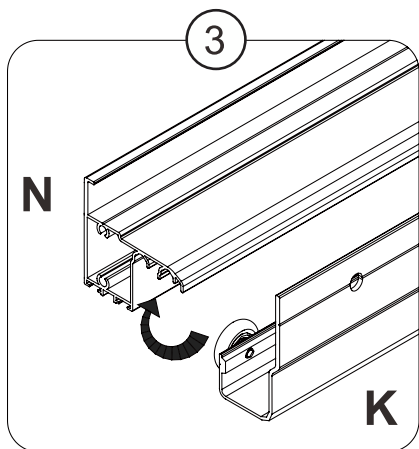

view from inside

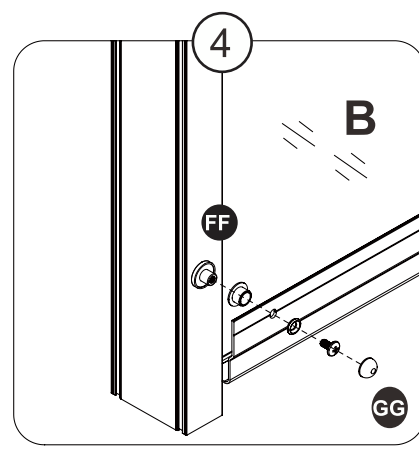

view from inside

STOPPER AND STRIPS INSTALLATION

1. Place the stopper (LL) on the track (F) on the fixed panel side. Find the correct position by closing the door on the stopper. It should prevent the door from hitting the track, but should not hinder the opening and closing motion of the door.
- 2-3. Mark the position of the stopper (LL) and drill a guide holes with $\varnothing 3\text{mm}$ (1/8in) drill bit.
4. Install the stopper (LL) on the track (F) using screws (DD) and insert the block (KK).
5. Place the covers (Q) on the tracks (F). Use a rubber mallet to make it easier.
6. Put the cap (HH) on the top and bottom tracks (G & N).
7. Place the gasket (T) between the fixed panel (D) and the track (F). Use a wood stick for help as it will fit tightly.

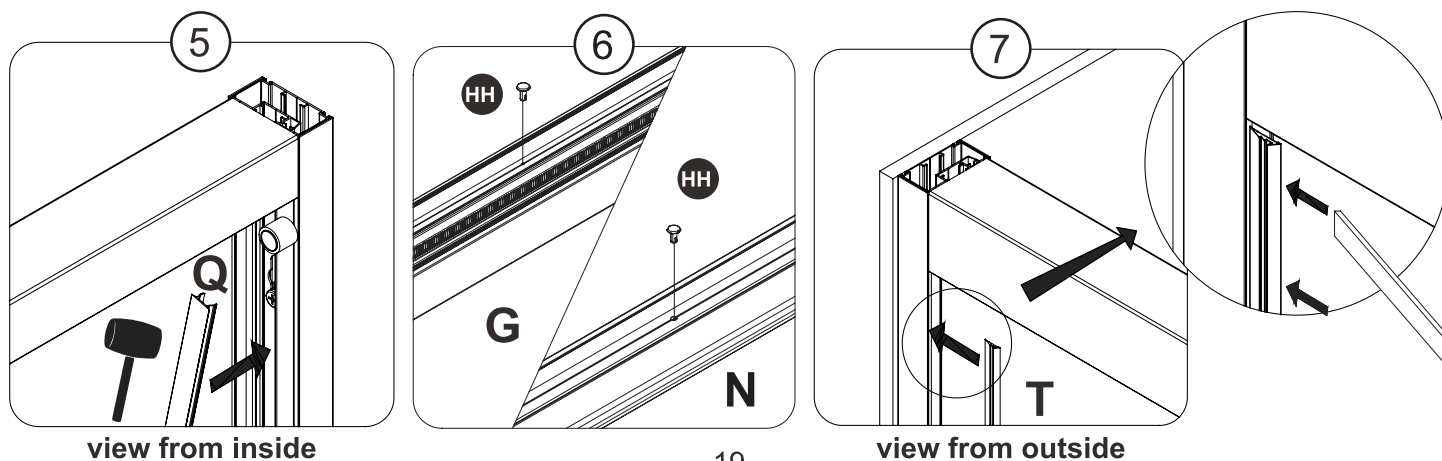
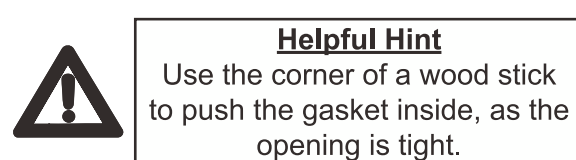
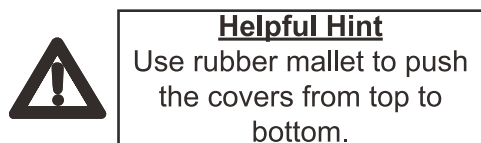
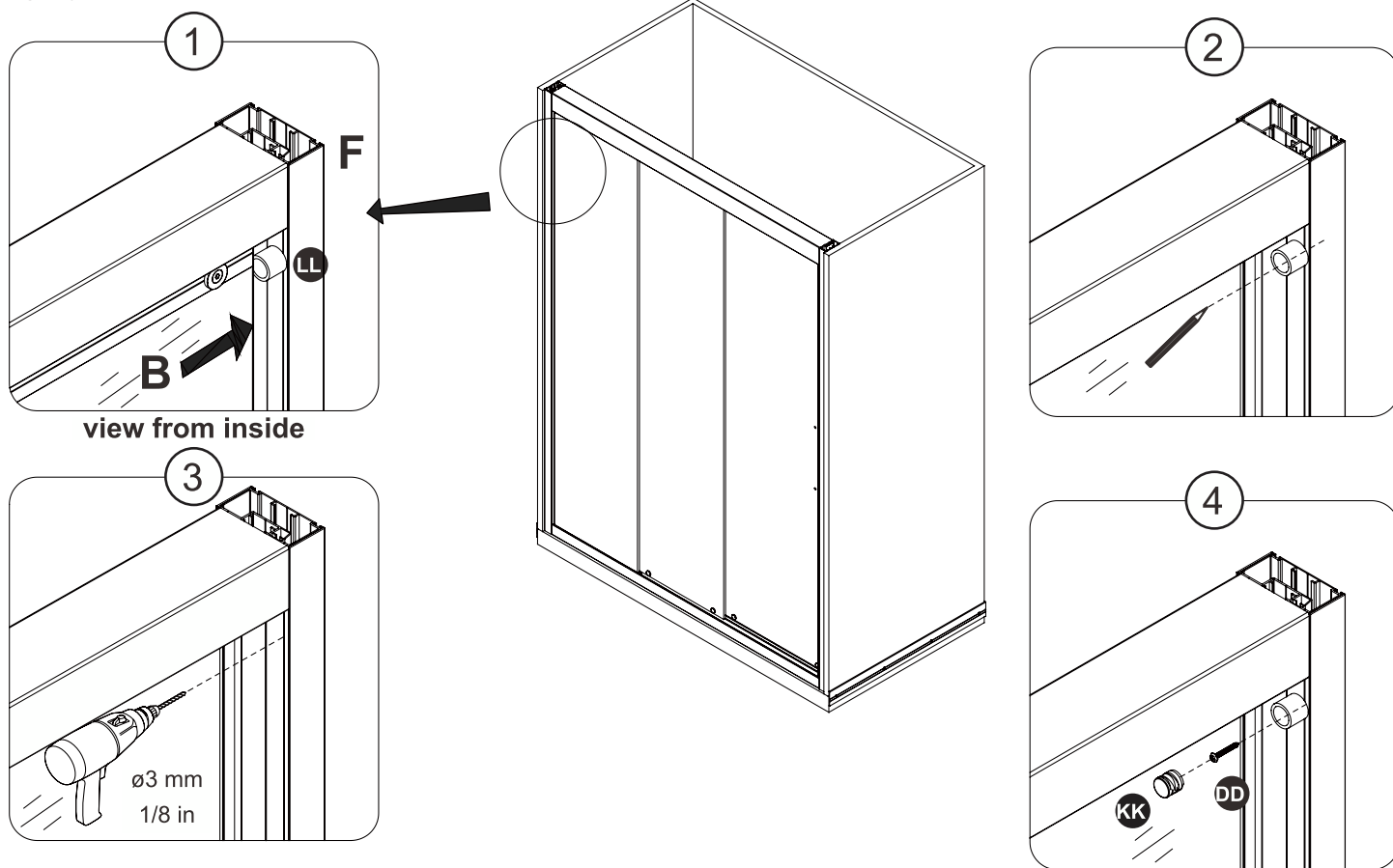

RUBBER STRIPS INSTALLATION

1. Place the vertical rubber strips (S & U) on the panels (B & C).
2. Cut the surplus part of the vertical rubber strip (U).
3. Place the vertical rubber strips (S & U) on the panels (C & D).
4. Place the door magnetic track (R) on the door panel (B).
5. Find out which side of the magnetic strip (P) attracts the door's magnet (R).
6. Insert the magnetic strip (P) into the track (F). Make sure to insert it with the attracting side facing the door's magnet.

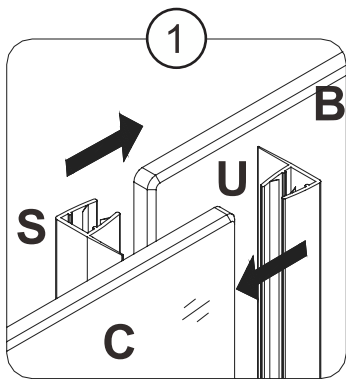

view from outside

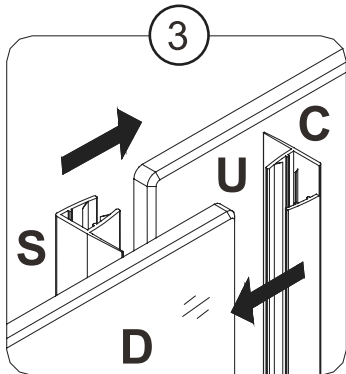
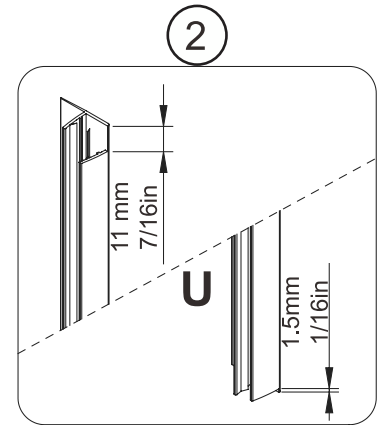

view from outside

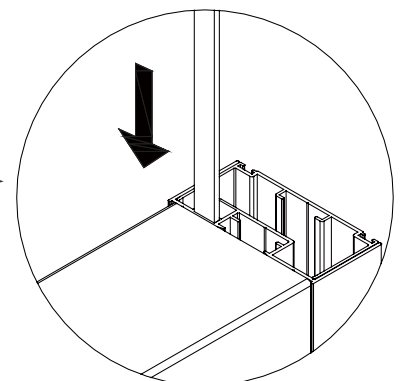
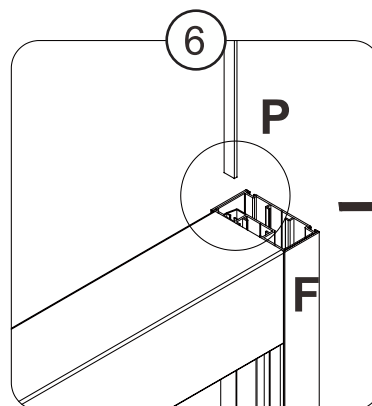
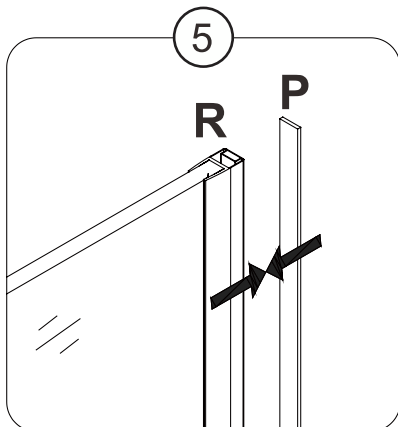
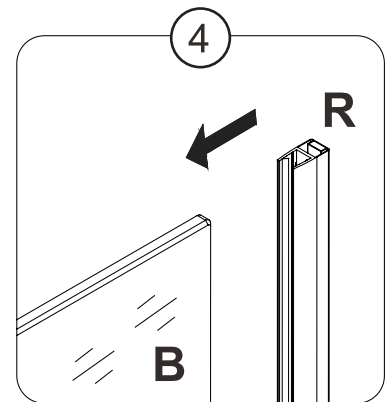

HANDLE INSTALLATION & SEALING

1. Install the door handle (H) using an Allen key.
2. Ensure that the door closes and opens smoothly, and that there is a tight connection between the side glass panels and the frame as well as the support bar.

Apply a clear silicone water sealant around the outside perimeter of any fixed shower components (horizontally between bottom of fixed side glass panel and the base, as well as vertically between the wall, glass frames, and any side glass panel).

Allow 24 hours for silicone to dry.

Improper application of silicone sealant may cause your shower to leak.

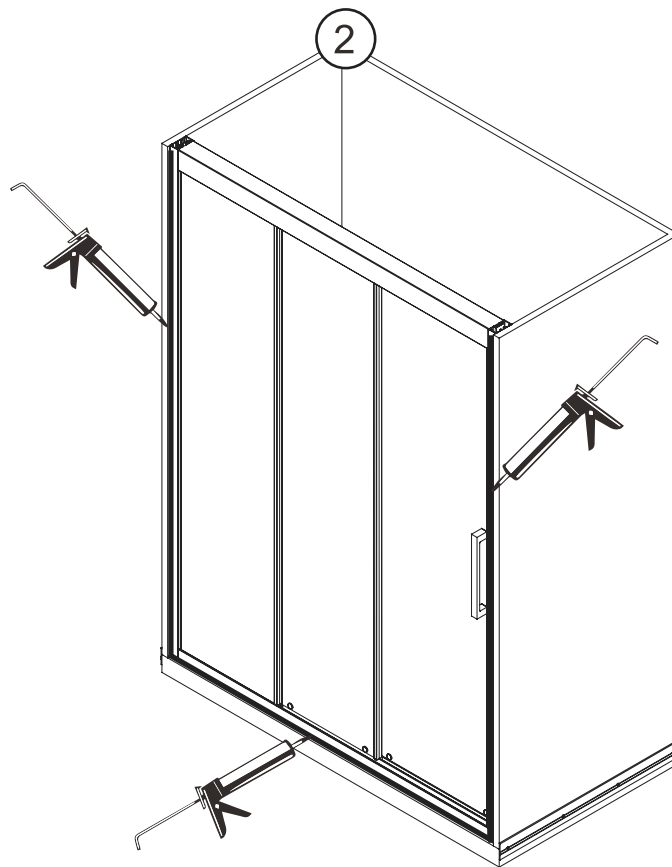
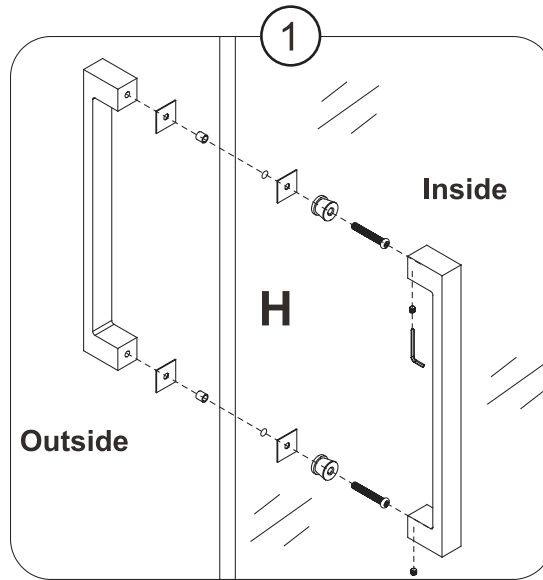

CARE AND MAINTENANCE

For the daily maintenance, use a wet cloth and a soft liquid cleaner.

Never use abrasive cleaners containing some acetone, chlorine or strong bleach, scrapers, metallic brushes, nor other objects or the products which can graze or tarnish surfaces.

Use a ratchet to strongly tighten any bolts used to support the fixed glass panels or doors panel (support bolts can withstand up to 250 lbf*in of torque).

Check these bolts every 4 months and re-tighten them if necessary.

LIMITED 5 YEARS WARRANTY

This warranty extends only to the original owner lend-user for personal household use only. For commercial uses, additional limitations may apply.

Distributor warrants your satisfaction with each shower. Should any shower not meet your satisfaction due to a visual defect, simply return it to your retailer with the original packaging, PRIOR TO INSTALLATION, for a replacement.

Distributor warrants shower doors to be free from defects in workmanship and materials under normal use and service for a period of five (5) years.

Distributor warrants acrylic surface against blistering or cracking and chipping resulting from defect in the acrylic surface material when used under normal conditions and service for a period of five (5) years from purchase date.

Distributor further warrants the structure of the acrylic shell against loss of water through fiberglass laminate of the acrylic body as a result of defect in materials and workmanship for a period of five (5) years from purchase date.

Distributor warrants, shower hardware (handles, hinges, rubber support clips, metal support bars and wall tracks) to be free from defects in workmanship and materials under normal use and service for a period of one (1) year.

Distributor will, at its election, repair, replace, or make appropriate adjustment where distributor optional inspection discloses any such defects occurring in normal usage within the warrantee periods.

Please note distributor is not responsible for installation or removal costs.

Modification of any shower enclosure components may void the warranty. This warranty does not cover any claim arising from abuse, misuse, negligence, accident, improper installation or operations on the part of the purchaser. This warranty is void if the distributor product is subject to alterations, or if repairs where done to the shower unit.

This warranty does not extend to any plumbing or components installed by dealers, installers or by any party other than distributor.

Implied warranties, including that of merchantability or fitness for a particular purpose, are expressly limited in duration to the duration of this warranty.

Distributor disclaims any liability for special, incidental or consequential damages.